



BUILD YOUR DREAMS HERE

The Hills of **ROSEMONT**



**LOT # 47
401 BLUE
VIOLET WAY
FEATURED AT**

\$775,900

A BEAUTIFUL WATERFRONT HOME SITE WITH DOCK IN A 400 ACRE GATED COMMUNITY OF QUIET ELEGANCE. WITH A LOCATION WITHIN MINUTES FROM THE RESEARCH TRIANGLE PARK, CARY, DURHAM, CHAPEL HILL AND RALEIGH. THIS COMMUNITY IS BORDERED BY WILD LIFE PARKLAND MANAGED BY THE ARMY CORPS OF ENGINEERS TO PROVIDE A GREATER SENSE OF PRIVACY.

CALL FOR MORE INFORMATION REGARDING COMMUNITY REQUIREMENTS.

DON'T MISS YOUR OPPORTUNITY, FOR THIS IS THE RIGHT TIME AND THE RIGHT LOCATION

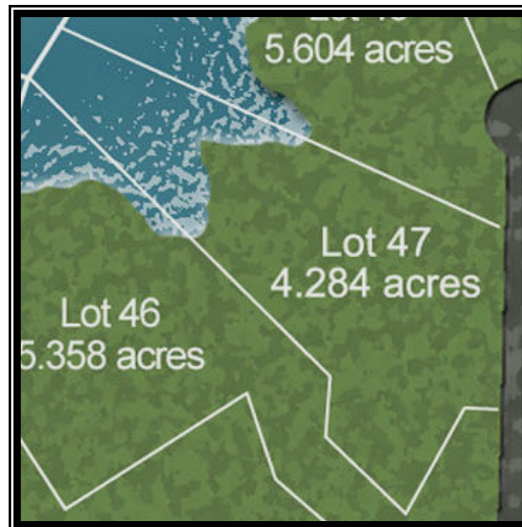

**CALL TODAY
(919)806-3262**

